

## **WARNING!!**

The attached Gold Medal Manual is for reference only and is not intended for any other purpose. The information contained in these on line manuals is subject to change at any time. Improvements are always being made to Gold Medal equipment and this information may not be the latest available for your purposes. It is critical that you call Gold Medal Products technical service department at 1-800-543-0862 for any questions about machine operations, replacement parts, or any service questions. Neither Gold Medal nor Snappy Popcorn represent that these on line manuals contain the most current information available for the product represented.

Part No. 49397  
Revised: October 2008

# Antique Deluxe 60 Special







## Popcorn Machine Instruction Manual

Model #2660GT



 **GOLD MEDAL**<sup>®</sup>  
**FUNFOOD EQUIPMENT & SUPPLIES**  
Cincinnati, OH 45241-4807 USA

## SAFETY PRECAUTIONS

	<p style="text-align: center;"><b>⚠ DANGER</b></p> <p>Machine <b>MUST</b> be properly grounded to prevent electrical shock to personnel. Failure to do so could result in serious injury, or death. Do <b>NOT</b> immerse the kettle, warmer, or any other part of this equipment in water. Always unplug the equipment before cleaning or servicing. Do not use excessive water when cleaning.</p>
	<p style="text-align: center;"><b>⚠ WARNING</b></p> <p>To avoid serious burns, do <b>NOT</b> touch the kettle while it is hot.</p>
	<p style="text-align: center;"><b>⚠ WARNING</b></p> <p><b>ALWAYS</b> wear safety glasses when servicing this equipment.</p>
	<p style="text-align: center;"><b>⚠ WARNING</b></p> <p>Any alterations to this equipment will void the warranty and may cause a dangerous situation. <b>NEVER</b> make alterations to the equipment. Make sure all machine switches are in the off position before plugging the equipment into the receptacle.</p>
	<p style="text-align: center;"><b>⚠ CAUTION</b></p> <p>This equipment is sold for commercial use only. Only personnel that are trained and familiar with the equipment should operate the equipment. Carefully read all installation, and operating instructions before operating the equipment.</p>
	<p style="text-align: center;"><b>⚠ CAUTION</b></p> <p>This machine is <b>NOT</b> to be operated by minors. Minors are classified as anyone under the age of 18.</p>

### NOTE

The information, specifications and illustrations contained in this manual represent the latest data available at time of publication. Right is reserved to make changes as required at the discretion of Gold Medal Products Company without notice.

# INSTALLATION INSTRUCTIONS

Unpack all cartons and check thoroughly for any damage that may have occurred during transit. Damage claims should be filed immediately with the transportation company. It is your responsibility to file claim immediately.

## OPERATING INSTRUCTIONS

### CONTROLS AND THEIR FUNCTIONS

#### LIGHT AND WARMER SWITCH

Turns on the heat to the bottom corn pan and light.

#### KETTLE MOTOR SWITCH

Turns on the motor which drives kettle agitator shaft.

#### KETTLE HEAT SWITCH

Turns on the heat element

### AMOUNT OF POPCORN AND OIL

Your new popper is equipped with a six ounce (177 ml) corn measure cup. We recommend flavored and colored coconut oil. Popcorn popped in coconut oil stays fresh longer. Coconut oil does not leave black deposits in your kettle like other oils. **Gold Medal recommends use of our 6oz Corn/Oil Kit – item #2836\***.

Corn charge - 6 oz. (177 ml)  
 Oil charge - 1.6 to 2.0 oz. (60 ml)  
 Flavacol - 1 tablespoon (8 cc)

\*All Gold Medal Corn/Oil kits come pre-measured.

### POPPING INSTRUCTIONS



1. Turn KETTLE HEAT and KETTLE MOTOR switch ON.
2. Make test pop with 3 kernels of corn and 1 oz. (30 ml) of oil.
3. Load pre-measured popcorn and oil pouch into kettle.
4. When corn has popped, dump kettle.
5. Repeat cycle starting with Item #3; always pop 3-5 batches for best popcorn.

## CARE AND CLEANING

	<p style="text-align: center;"><b>⚠ WARNING</b></p> <p><b>Unplug your machine before cleaning glass panels and case. Never immerse the kettle in water, this will ruin the electrical components and automatically void the warranty.</b></p>
---	---

Each time you finish a series of poppings, wipe the outside of the kettle with a soft cloth to remove any oil drippage on the outside of the kettle. After you finish popping for the day, allow kettle to cool until it is not too hot to handle, but still warm. Unplug kettle and remove it from the machine. With a cloth, wipe out the inside of the kettle, kettle lid, crossbar, outside and underneath of the kettle.

Cleaning the cabinet of your machine is easy. Take a clean cloth and wipe excess grease from the glass. Wipe the outside of the machine also.

**NOTE:** Never use a glass or plastic cleaner that contains ammonia. It can crack the plastic on the machine.

## MAINTENANCE INSTRUCTIONS

	⚠ DANGER
	Improper installation, adjustment, alteration, service or maintenance can cause property damage, injury, or death. Read the Installation, Operating, and Maintenance Instructions thoroughly. Installation should be performed by a certified electrician.

	⚠ WARNING
	Adequate eye protection must be used when servicing this equipment to prevent the possibility of injury.

	⚠ WARNING
	Do not immerse the kettle, warmer, or any other part of this equipment in water. Always unplug your machine before servicing.

	⚠ CAUTION
	THE FOLLOWING SECTIONS OF THIS MANUAL ARE INTENDED ONLY FOR QUALIFIED SERVICE PERSONNEL WHO ARE FAMILIAR WITH ELECTRICAL EQUIPMENT. THESE ARE NOT INTENDED FOR THE OPERATOR.

## ACCESSORIES

<u>Description</u>	<u>Part Number</u>
Shipping Carton	49026
Corn Measure Cup	49049
Scoop	2071
Flavacol Cup	47678

## ORDERING SPARE PARTS

1. Identify the needed part by checking it against the photos, illustrations, and/or the parts list.
2. When ordering, please include part number, part name, and quantity needed.
3. Please include your model name, serial number, and date of manufacture (located on the machine nameplate) with your order.
4. Address all parts orders to:

Parts Department  
Gold Medal Products Co.  
10700 Medallion Drive  
Cincinnati, Ohio 45241-4807

or, place orders at:

(800) 543-0862

(513) 769-7676

Fax: (513) 769-8500

E-mail: [info@gmpopcorn.com](mailto:info@gmpopcorn.com)

Web Page: [www.gmpopcorn.com](http://www.gmpopcorn.com)

# POPPER ASSEMBLY

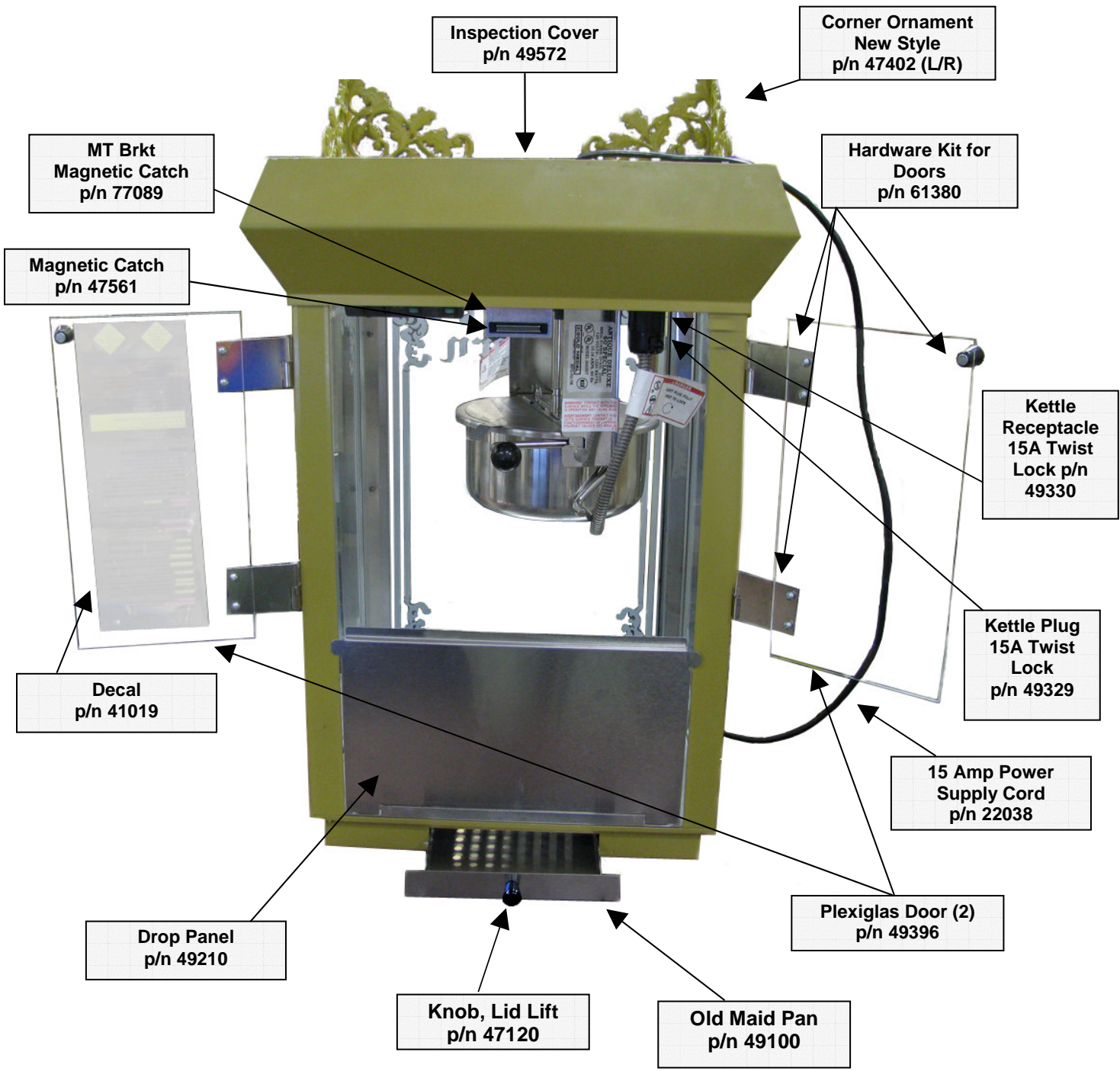



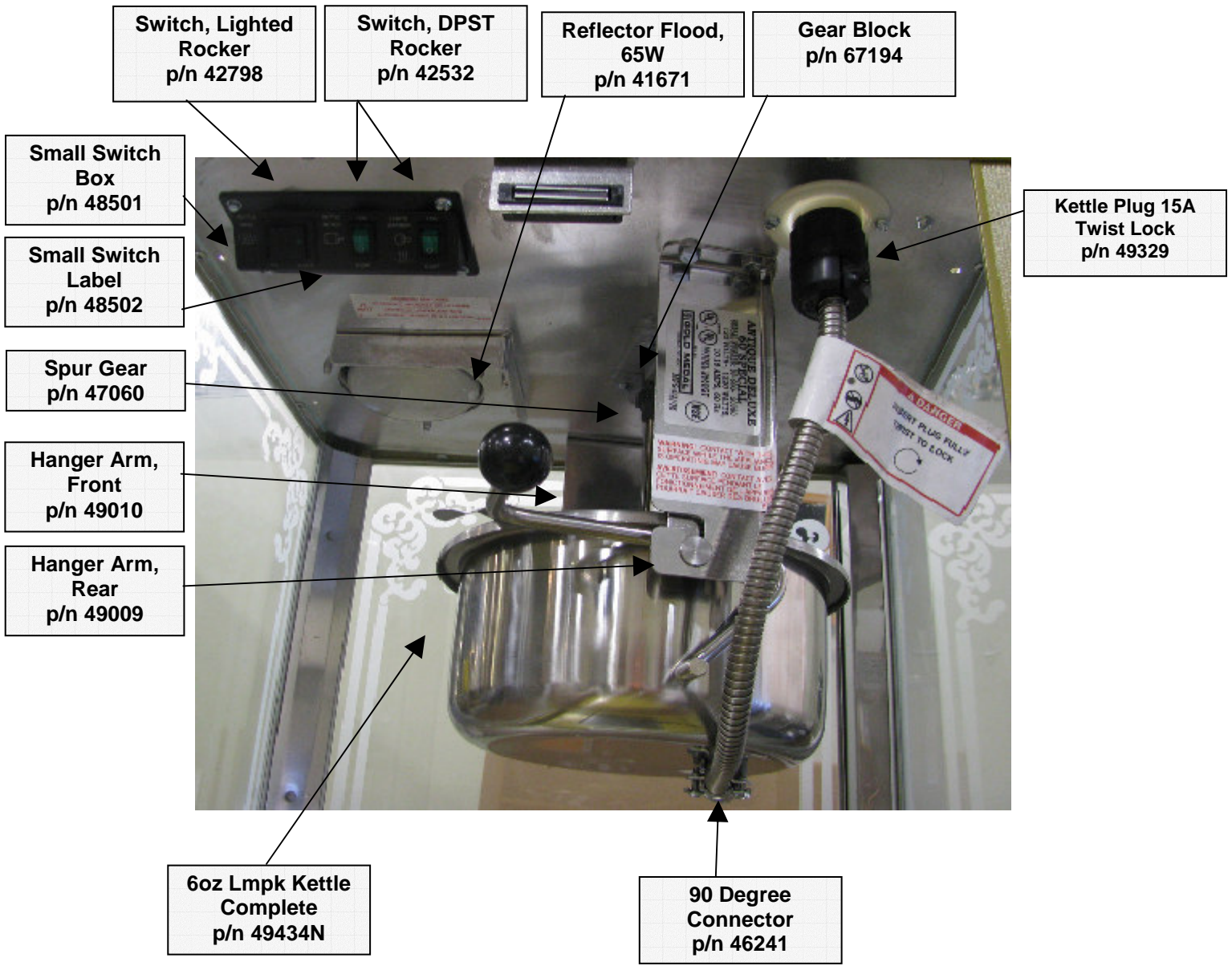

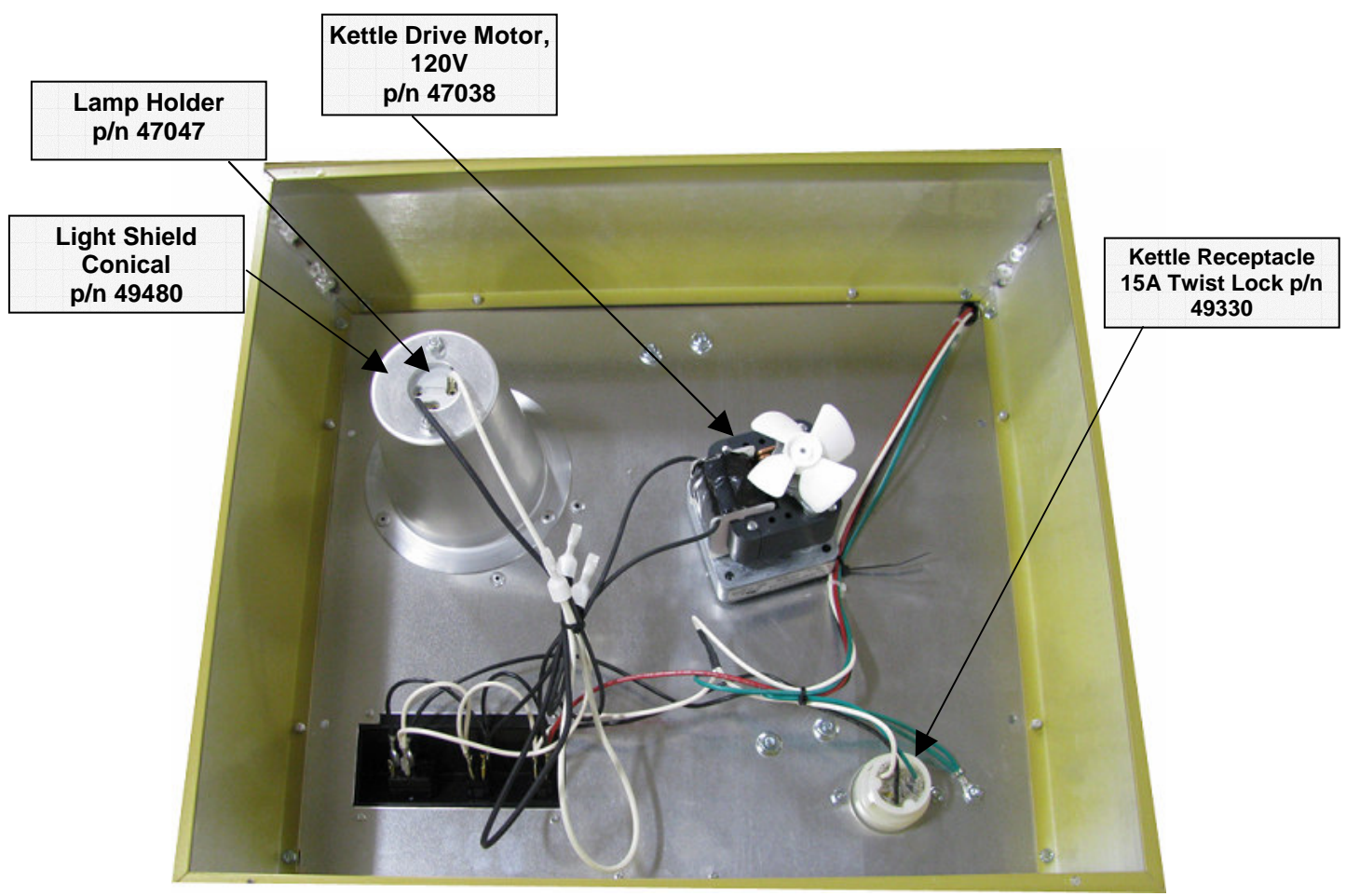
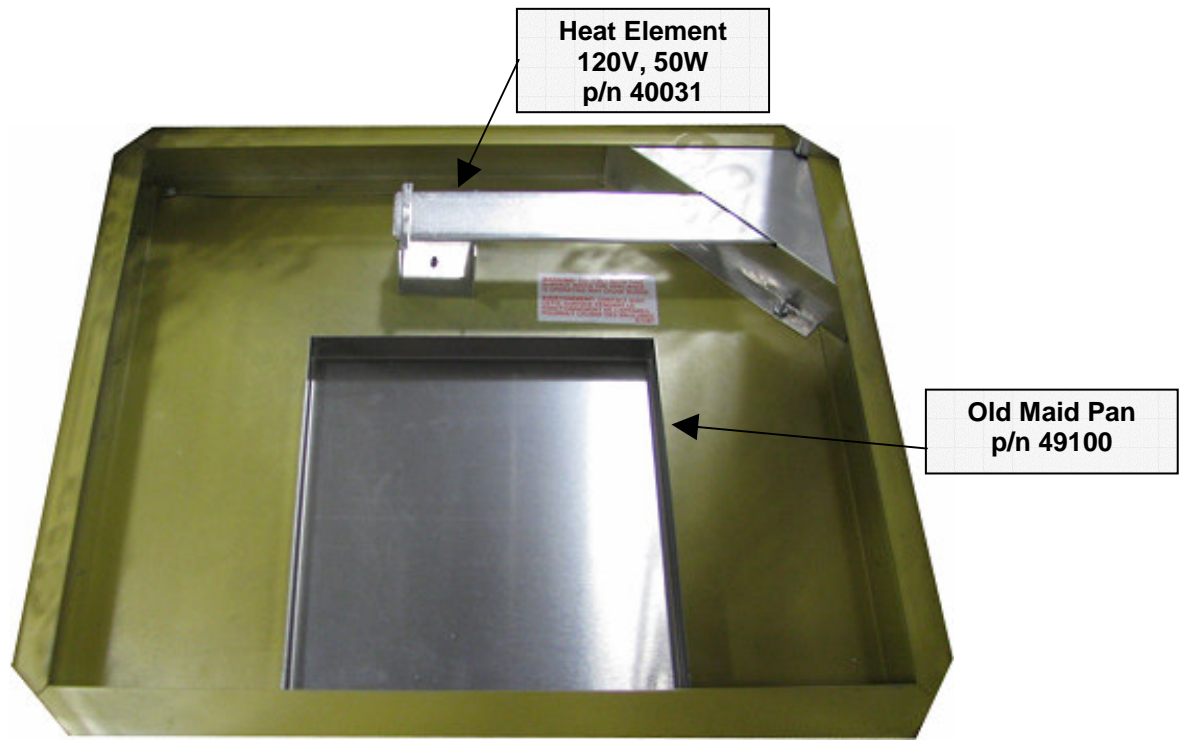

# 6 oz. KETTLE ASSEMBLY (Complete Assembly #49434N)

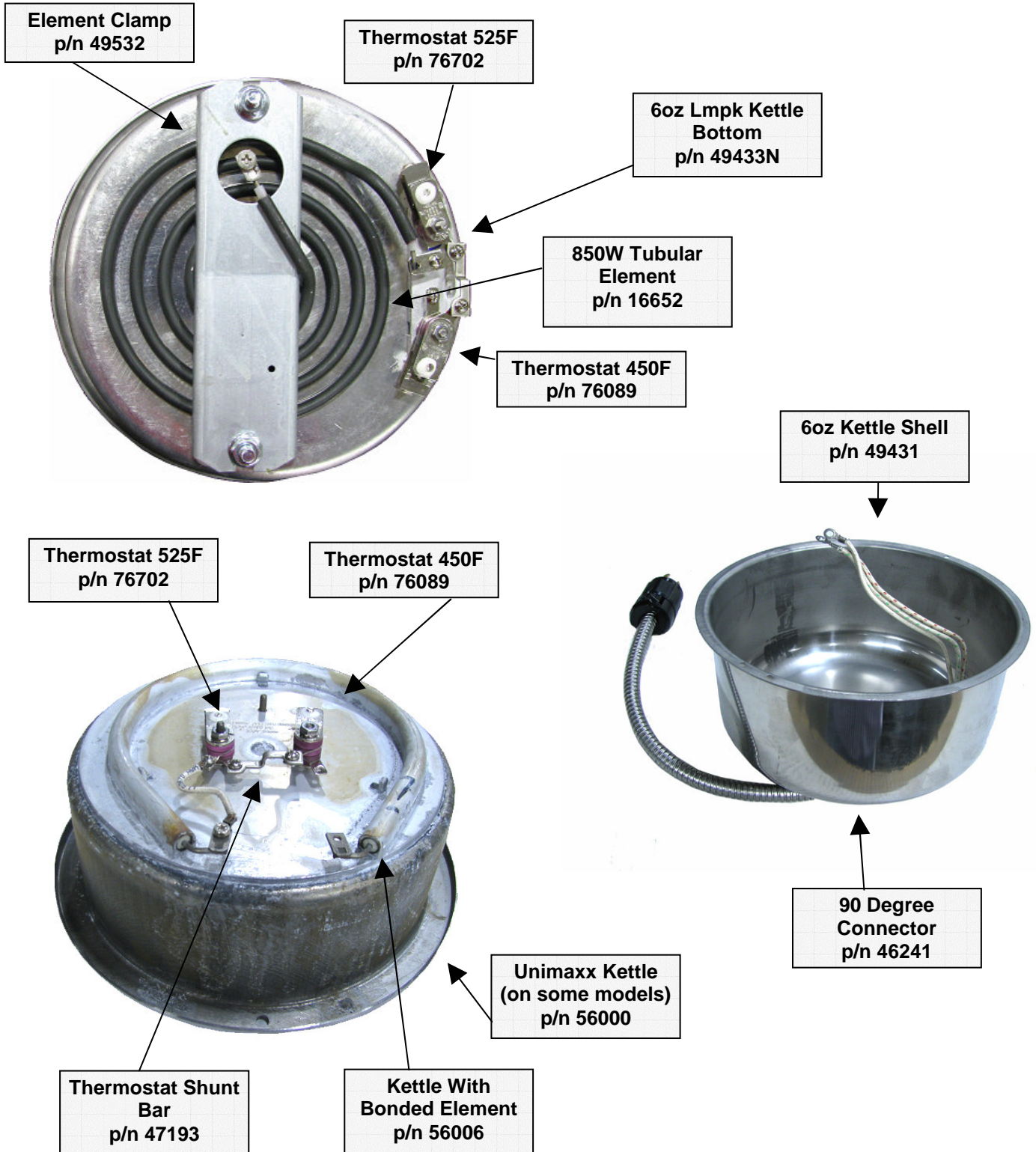

## 6 oz. KETTLE ASSEMBLY (Complete Assembly #49434N)

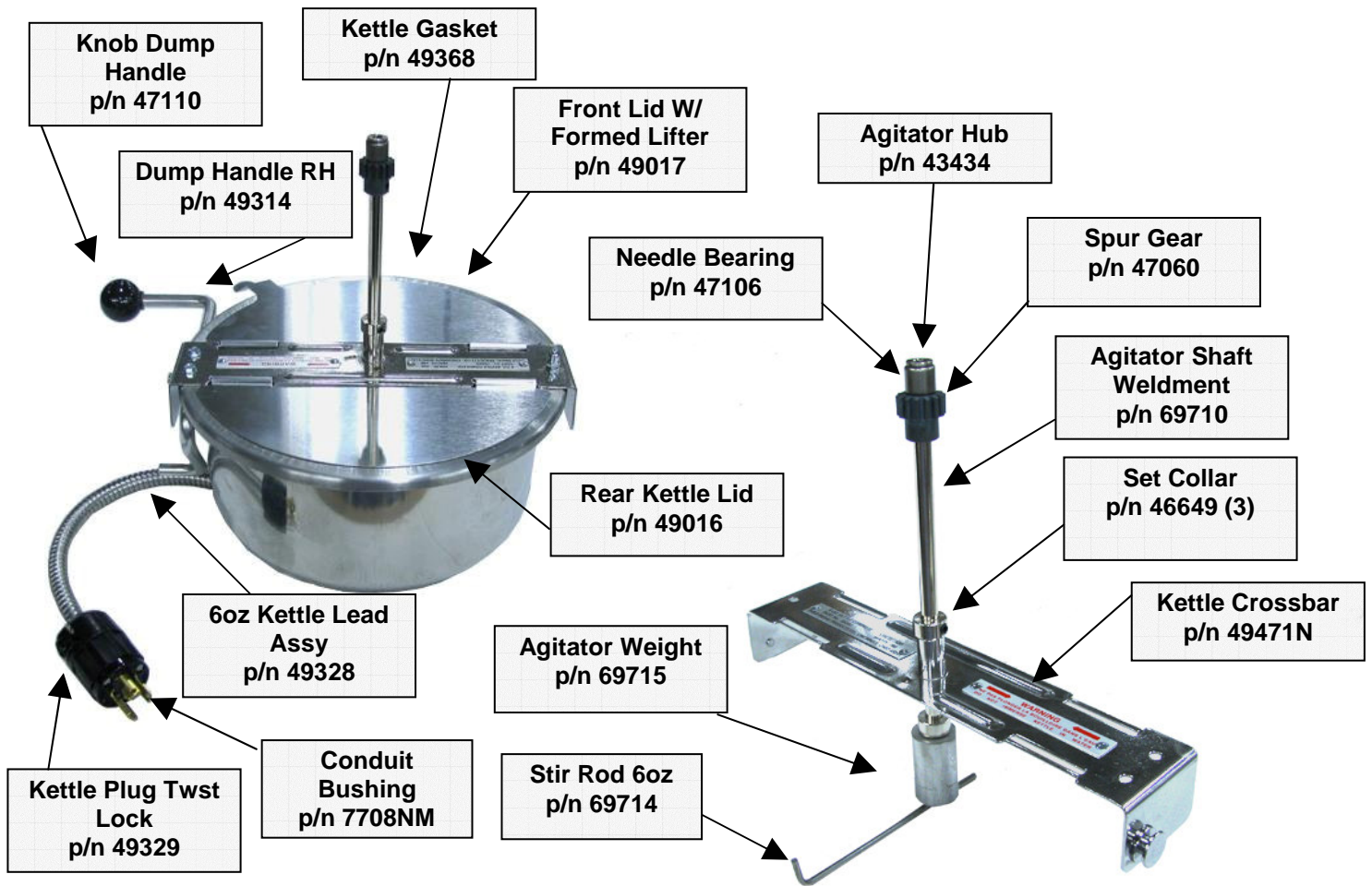

# ELECTRICAL SCHEMATIC

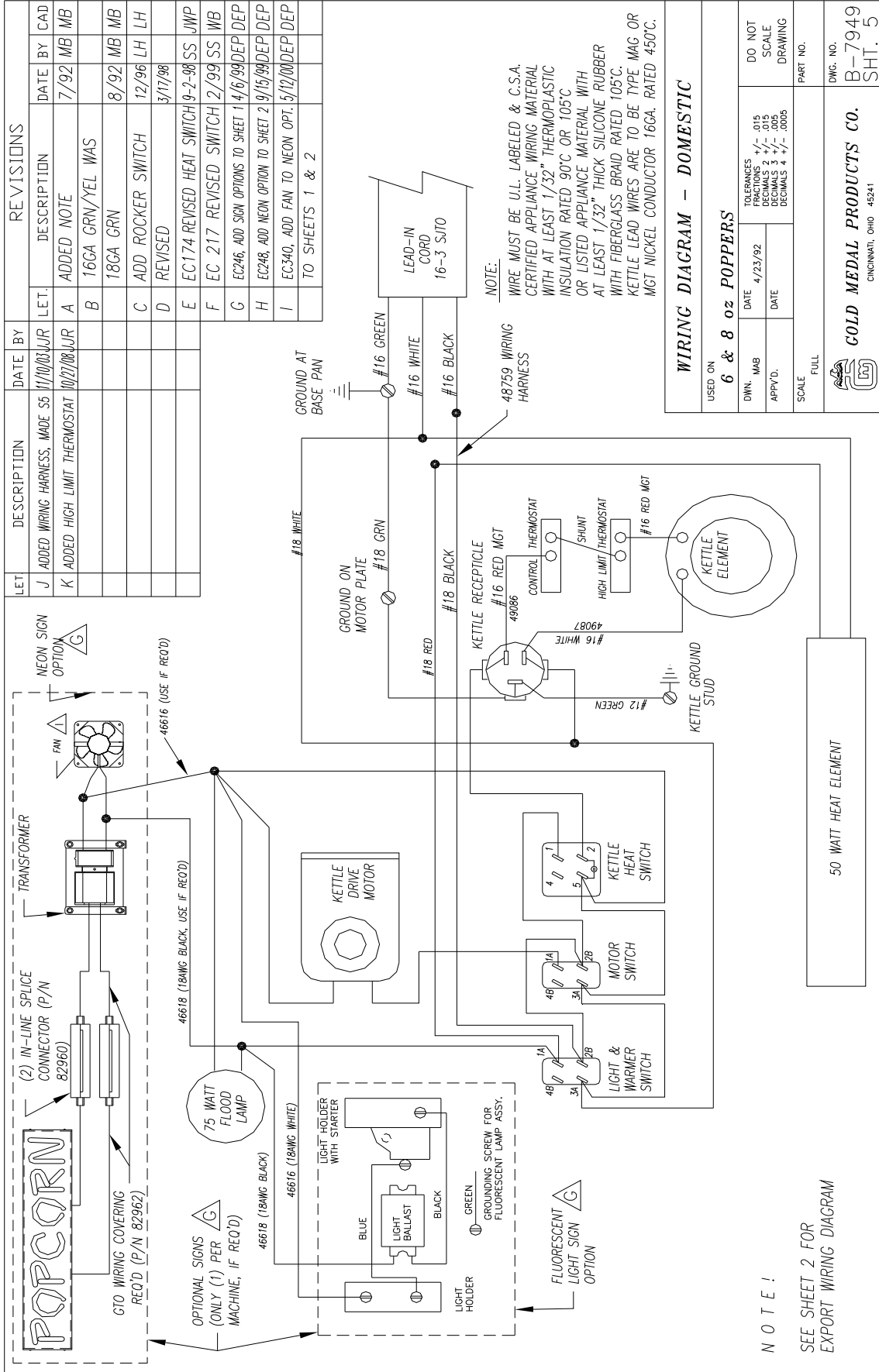

**WIRING DIAGRAM - DOMESTIC**

USED ON  
**6 & 8 oz POPPERS**

DWN: MAB	DATE: 4/23/92	DO. SCALE: +/-.015
APPVD:	DATE:	DECIMALS 2 +/-.015
SCALE: FULL		DECIMALS 3 +/-.005
		DECIMALS 4 +/-.0005

PART NO.  
DWC. NO.  
**B-7949**  
**SHT. 5**

**GOLD MEDAL PRODUCTS CO.**  
CINCINNATI, OHIO 45241

**NOTE:**  
SEE SHEET 2 FOR  
EXPORT WIRING DIAGRAM

## WARRANTY

WE WARRANT to the original purchaser the Gold Medal equipment sold by us to be free from defects in material or workmanship under normal use and service. Our obligation under this warranty shall be limited to the repair or replacement of any defective part for a period of six (6) months from the date of sale to the Original Purchaser with regard to labor and two (2) years with regard to parts and does not cover damage to the equipment caused by accident, alteration, improper use, voltage, abuse, or failure to follow instructions.

THIS WARRANTY IS IN LIEU OF ALL OTHER WARRANTIES EXPRESSED OR IMPLIED, AND OF ALL OTHER OBLIGATIONS OR LIABILITIES ON OUR PART, INCLUDING THE IMPLIED WARRANTY OF MERCHANTABILITY. THERE ARE NO WARRANTIES WHICH EXTEND BEYOND THE DESCRIPTION ON THE FACE HEREOF. We neither assume, nor authorize any other person to assume for us, any other obligation or liability in connection with the sale of said GOLD MEDAL equipment or any part thereof.

The term "Original Purchaser" as used in this warranty shall be deemed to mean that person, firm, association, or corporation who was billed by the GOLD MEDAL PRODUCTS COMPANY, or their authorized distributor for the equipment.

THIS WARRANTY HAS NO EFFECT AND IS VOID UNLESS THE ORIGINAL PURCHASER FIRST CALLS GOLD MEDAL PRODUCTS COMPANY AT 1-800-543-0862 TO DISCUSS WITH OUR SERVICE REPRESENTATIVE THE EQUIPMENT PROBLEM, AND, IF NECESSARY, FOR INSTRUCTIONS CONCERNING THE REPAIR OR REPLACEMENT OF PARTS.

*NOTE: This equipment is manufactured and sold for commercial use only.*



**GOLD MEDAL PRODUCTS COMPANY**

**10700 Medallion Drive**

**Cincinnati, Ohio 45241-4807 USA**

**[www.gmpopcorn.com](http://www.gmpopcorn.com)**

**Phone: 1-800-543-0862**

**Fax: 1-800-542-1496**

© The text, descriptions, graphics and other material in this publication are the proprietary and exclusive property of Gold Medal Products Company and shall not be used, copied, reproduced, reprinted or published in any fashion, including website display, without its express written consent.